

Hypersen 6-axis torque sensor



Measurement of force and torque on each XYZ axis
With high-performance processor and 24 bit ADC digital output

Output with high SNR

Overload up to 350%

Data speed up to 2000Hz

Low drift on zero point, on cross-axis effects, and at low temperature conditions

Available communication connections: Ethernet, EtherCAT and RS-485, analog

Suitable for industrial robots, cobots, automation and more

Hypersen 6-axis torque sensor

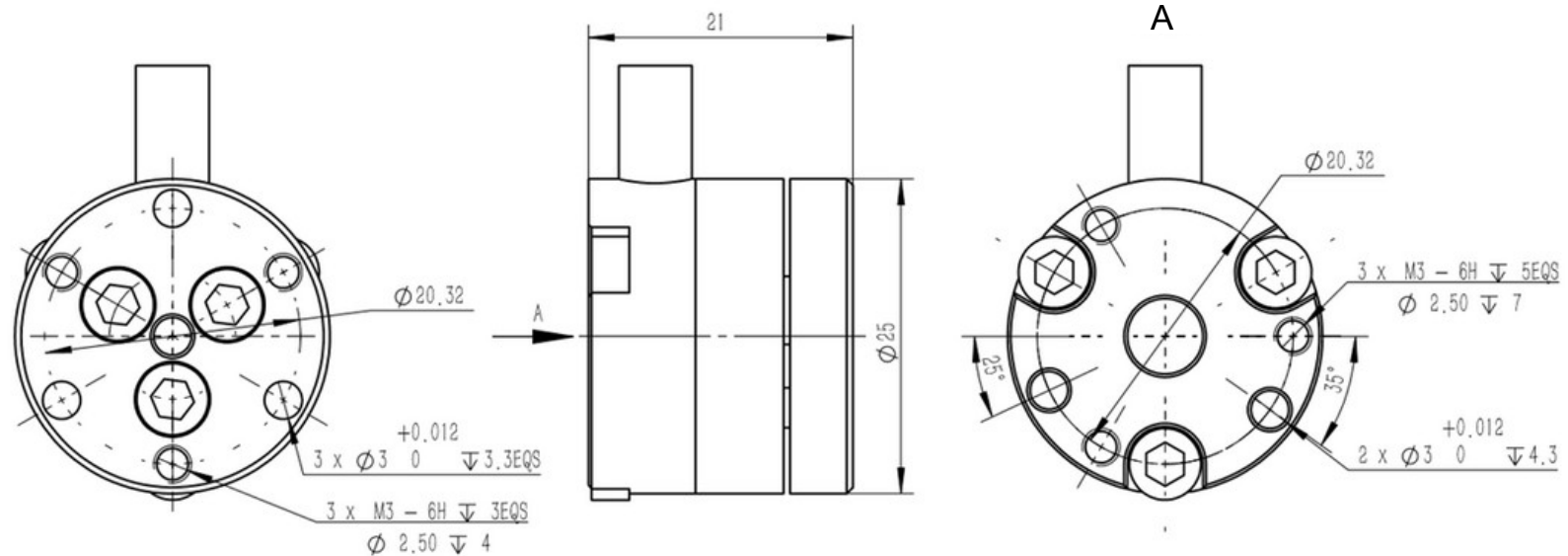

Hypersen 6-axis torque sensor



Model	HPS-FT025	Operating temperature	-10~55°C
System architecture	Digital output+Connector	Power consumption	0.5w
Measuring range	$\pm 150\text{N}(\text{Fxy})$	Communication interface	Ethernet. EtherCAT.RS485.Analog
	$\pm 200\text{N}(\text{Fz})$	Weight	28g
	$\pm 4\text{Nm}(\text{Mxy})$	Size	21*25mm(diameter)
	$\pm 4\text{Nm}(\text{Mz})$	Power supply	8-36V
Precision	0.05N(Fxy)	Connector	Aerial plug
	0.05N(Fz)	Data output rate	2000Hz (max)
	0.001Nm(Mxy)	Protection	IP65
	0.001Nm(Mz)	Hysteresis	0.1(F.S.)
Non-linearity	<1%	Overload	350%
Creep	<2%	Signal noise	0.03N(x,y axis)
Crosstalk	<1(F.S)		0.12N(z axis)

Hypersen 6-axis torque sensor



Contacts:
SD Companies SRL
Via Villafranca 25
70022 - Altamura (BA)
+ 39 3332933211
info@sdcompanies.it
PI: 08301650720

SD Companies SRL:

- Provides the product
- Integrate the device into your machines
- Develop any software for specific usage applications
- Technical assistance